

LA Coupler

The Newsletter of the Los Angeles Division of the NMRA



LAMRS is Back!

Los Angeles Division
Pacific Southwest Region
National Model Railroad Association, Inc.
www.ladiv-nmra.org



In This Issue:

Milw. Road Open House

The New & Improved LAMRS

...and more!



Features

Director's Report.....	4
Milw Road Northern Division.....	6
Superintendant's Report.....	9
LAMRS Update.....	11
Membership Report.....	20
Financial Report.....	22
Advisory Board Contact List.....	23
Upcoming Events.....	24

On the Cover.... The Great Lakes and Western is back and better than ever! Read all about how the Los Angeles Model Railroad Society reimagined their layout, and turned what could have been a devastating defeat into a triumphant return.

LA Coupler Deadlines

Publication Team

The LA Coupler is always looking for submissions, articles, photos, or ideas. Please reach out to the Editor for more information:

Lisican@gmail.com

Submission Deadlines

Spring Issue: February 1

Summer Issue: May 1

Fall Issue: August 1

Winter Issue: November 1

Editor:

Nick Lisica

1709 E Erie St

Long Beach, CA 90802

Lisican@gmail.com

Issue Photographers:

Jeff Traintime

LAMRS

Electronic PDF Distribution:

Kevin Spady

Publication Information for the LA Coupler

The official publication of the Los Angeles Division, Pacific Southwest Region (PSR), National Model Railroad Association (NMRA). The LA Coupler is published quarterly by the Los Angeles Division of the National Model Railroad Association and is available online at: www.ladiv-nmra.org

All materials, articles, and advertising must be submitted to the Editor and in an electronic format. Contact us for a copy of our submission guidelines. Advertisers may contact the Editor to request guidelines and a rate card. Subscribers with an e-mail address on file will receive the PDF version. Copyright 2022, LA Division Pacific Southwest Region, National Model Railroad Association.

Permission to reprint granted to all affiliates of the NMRA. Others may request permission to reprint from the Editor.

Except for Official Reports, opinions expressed are those of the author, and do not necessarily represent those of the LA Division, PSR, or the NMRA.

Thank you for supporting the LA Division!

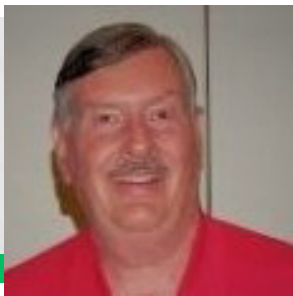

Director's Report

- Vic Cavalli

My first report of the New Year. Happy 2026 to you; hope it has been all good thus far.

Only a few odds-and-ends to share this time around – most of it coming from a Pacific Southwest Region (PSR) Board of Directors (BoD) special meeting call by President Joel Morse on Sunday, January 25th.

First, a bit more detail on how National's new rebranding program, NMRA Vision 2035, will affect regions. Headquarters, in an effort to standardize "appearance", has banned regions from using logos effective January 1, 2026. Therefore, the PSR, after due consideration, voted to adopt its new image consisting of the NMRA "on wheels" logo followed by a "bar" underneath it, then the Region's name spelled out below that, followed by another bar. National does permit each region to select what color they wish to generally display their emblem by, with the BoD decided on Dark Blue.

Here's what our new logo looks like:



Also shared was that divisions will be allowed to keep their existing logos, but they may only use them when they appear directly below the Region's emblem; "standalone" usage is no longer permitted. Same to be true of convention and/or event emblems.

Divisions will be allowed to pick their own specific "color" by which they will display their new "assembled" emblem too. (Our Los Angeles Division's Executive Board has not yet taken up this matter.)

A financial impact of all this "rebranding" is the PSR, and each of its Divisions, must now purchase new banners, letterhead, business cards, etc... as well as update all their social media sites and materials as soon as possible.

Director's Report

- Vic Cavalli

In other news, the BoD decided to schedule their mid-year meeting for March 22, 2026, starting at 4:00 pm PDT, by Zoom application. Among items that will be reviewed is National's new Division Standards document – providing universal guidance/expectations of all its Divisions. A “report card” system, for tracking compliance, shall likely be discussed too.

National's *Superintendent Handbook/Superintendent Expectations* manual was recently re-discovered. It is scheduled to be distributed to BoD members prior to the meeting so we may provide feedback.

A status report by the PSR's Convention Subcommittee on their efforts to update the Region's Convention Planning Manual is scheduled to be received as well.

Finally, **Don Fowler**, Chair of this year's PSR Convention, All Aboard for 2026, to be held in San Diego, CA (September 9th-13th) indicated preparations are progressing smoothly, with registration now totaling over 85 individuals.

Chris Thompson, Chair for the PSR's 2027 Convention, shared its planning committee is now formed, with events being held in Phoenix, AZ area – at the same Mesa, AZ hotel used in 2019 – September 29th – October 3rd 2027.

That's it for now. Thanks for reading along.

HO Northern Division

- Jeff Traintime



I recently had a wonderful day. The event was an Open House for my HO Northern Division Layout sponsored by the LA Division of the NMRA. If you have a layout, I highly recommend taking the opportunity to have your own event. The Division takes care of all the promotion, and lets you choose the dates and time. With dozens of people moving about, no damage was inflicted on the layout. One thing I've always been concerned about when having people over is that there will be someone who nitpicks and criticizes. Not so with your NMRA friends. I received no criticism, but everyone was generous with their compliments. Even if you are aware of things about your layout that you think you may have done better, who better to give you advice to solve your problems than folks who love our hobby enough to join the NMRA? These are good people!

Here are a few ideas of how to prepare:

- 1) Spend some time cleaning up the dust and gluing those trees and people that might have fallen. Check for derailed cars and structures that have moved out of place.
- 2) Move things out of the room that might impede traffic or distract focus from your trains
- 3) Run all the trains you plan to show to check for problems, and clean track and wheels where necessary
- 4) It helps if you have a spouse or friend around to help manage things because you'll want to talk to as many guests as possible.

HO Northern Division

- Jeff Traintime

- 5) Your room might occasionally get crowded if several cars arrive at once. It's helpful if you have a space for overflow. Even a few chairs in the yard or garage will do the trick.
- 6) A little bit of signage to direct people to the layout or set out some rules is helpful.

At times, my Open House had somewhat of a party atmosphere. Some folks traveled quite a distance to be here, and they loved watching trains and talking about them. As much as I wanted to, I didn't get enough time to talk with every guest, but conversations sprung up spontaneously among people who had just met. Even the overflow area was full of chatter about modeling and trains. It was a wonderful, joyous experience.



SurfLiner Convention Cars



N Surfliner Car



HO Surfliner Car

HO and N Scale *SurfLiner* convention cars are still available! They can be yours for \$15.00 each (originally sold for \$30 at the convention). Each purchase includes a *SurfLiner* convention pin. Please contact Vic Cavalli for information: director@ladiv-nmra.org



Superintendent's Report

- Jeff Smith

Dear NMRA LA Division Members,

As we continue moving forward this year, I want to take a moment to share a few updates and reflections about our Division. One of the greatest strengths of the NMRA Los Angeles Division has always been the people—modelers helping modelers, sharing ideas, techniques, and encouragement that make this hobby so rewarding.

Membership – Full Steam Ahead

I'm happy to report that our membership has grown by a few people recently, which is great news. Let's keep that momentum going. Growing our Division doesn't happen by accident—it happens because members like you share the hobby with others.

If you know someone who enjoys trains, history, electronics, modeling, or just building things with their hands, invite them to one of our events or layout tours. Our hobby has something for everyone. My goal is to continue increasing membership in the LA Division, but I cannot do that without your help.

Helping Each Other – The Heart of the Hobby

One of the best things about being part of the NMRA is the willingness of members to help each other. Whether it's solving a tricky DCC issue, sharing scenery techniques, or simply offering advice on a project, we all benefit when we work together.

In his recent message, NMRA President Gordy Robinson, MMR®, encouraged members to focus on growing our skills and mentoring others. His message was simple but powerful: no model railroader should ever have to “model alone.”

Consider sharing a technique you've mastered—maybe DCC programming, weathering rolling stock, trackwork tips, or static grass scenery—at a Division event or with another member. Even if you're still learning yourself, the journey is just as valuable as the destination.

Annual Membership Banquet – A Night to Remember

Our Annual Membership Banquet is coming up, and it's shaping up to be a fantastic evening of food, fun, and fellowship.

 **March 14, 2026 5:30pm**

 **Frantone's Pizza & Spaghetti Villa – Cerritos**

\$ \$25 per person



Superintendent's Report

- Jeff Smith

This evening is always a highlight of the year for the Division. We'll review what the Division has accomplished, discuss our plans for the coming year, and most importantly enjoy time together as fellow model railroaders.

We'll also have some great guests joining us:

Our Guest speaker : *Paul Ellis from ScaleTrains*

And of course there will be raffle prizes, laughs, and plenty of railroad talk. For the cost of a good meal, you get an evening of camaraderie and entertainment with fellow modelers.

Just remember—space is limited, so be sure to RSVP to the email address on the flyer as soon as possible.

Looking Ahead

We are continuing to plan layout tours, events, and activities that bring members together. These events are the backbone of our Division and help us learn from one another while strengthening friendships within the hobby.

If you have a layout you'd be willing to open to members—even if it's still under construction—we would love to hear from you. Seeing how others approach the hobby is one of the best ways we all improve our own modeling.

Thank You

The LA Division is a special group because of its members. We have talented model builders, historians, operators, electronics experts, scenery artists, and creative minds who make this hobby come alive.

Let's continue helping each other, welcoming new members, and sharing the joy of model railroading. I look forward to seeing many of you at the banquet and upcoming events.

Until then, keep the high green and the trains running.

Warm regards,

Jeffery L. Smith

Superintendent

NMRA Los Angeles Division 

New and Improved Great Lakes & Western

Ira Abramowitz, Mike Artner, Marty Bradley, Bob Myrtle, Lloyd Lehrer, Mike Shields and Tim Steinmeier contributed to this article

How Time Flies When You are Re-Creating a Model Railroad!



Four years ago, after four long and difficult days of deconstructing our previous layout, work began on what would become a far more ambitious and refined version of the Great Lakes and Western Railroad (GL&W) (See *LA Coupler*, Issue 2, 2023). What now stands is not merely a rebuild, but a comprehensive rethinking of the railroad—its operations, scenery, reliability, and long-term enjoyment.

On April 28, 2025, a major milestone was reached when the completion of the mainline was celebrated with the symbolic placement of a golden spike.



New and Improved Great Lakes & Western

Layout Overview

The GL&W is a double-deck, shelf-style layout with a third level dedicated to staging.

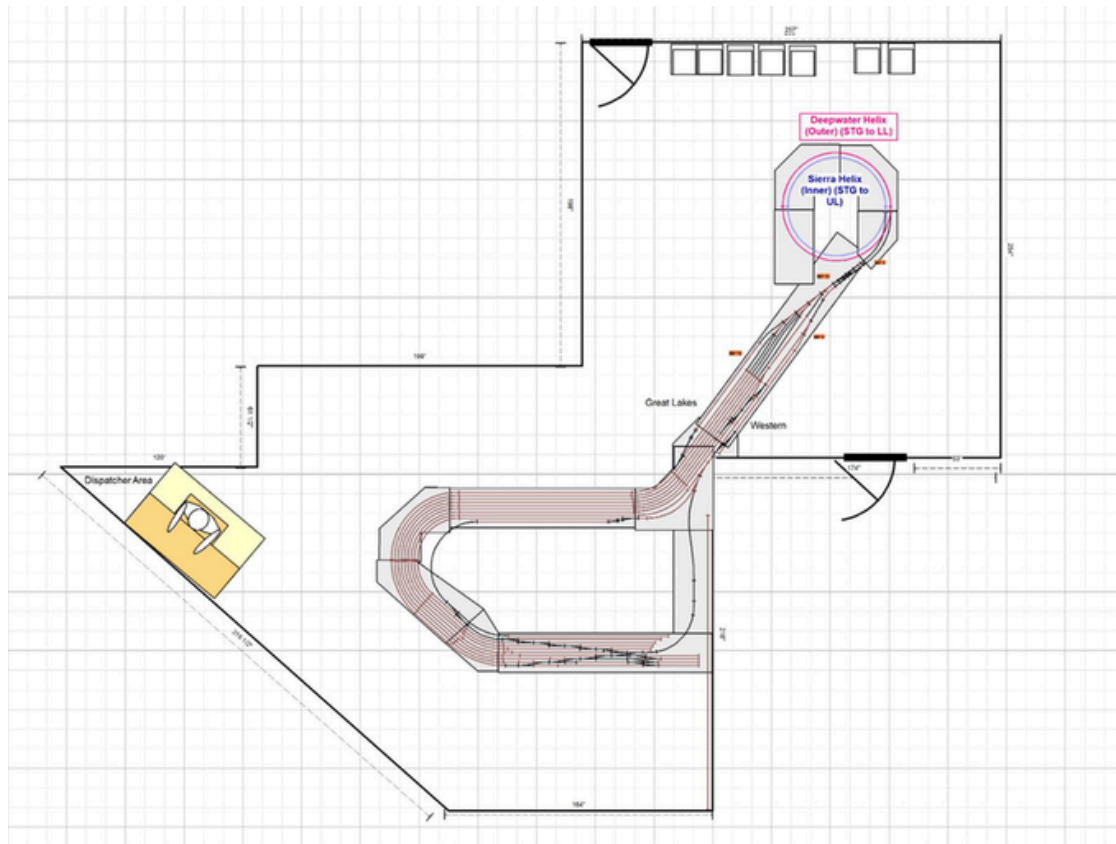

The two levels above staging are the sceniced working levels of the layout. Vertical transitions between levels are handled by two helixes, one of which is double-tracked to allow simultaneous two-way traffic between decks. This design significantly improves operational fluidity and reduces congestion during operating sessions.

The mainline, including four passing sidings and the helixes, is approximately 400 feet long, and the branch lines and industry locations adds an additional 900 feet of track. The Mead Yard and staging locations add 700 feet of track. This results in a layout that emphasizes long runs, purposeful switching and realistic traffic flow. We have installed adjustable color LED lighting above most of the finished track and that improves the effect on the scenery and structures.

Seven of the nine switching areas have been completed. On the first level, these are 1) the City of Industry, Harbor City comprising 2) Harbor City East, 3) Harbor City West and 4) the Alameda Corridor (see GL&W RR First Level Track Plan).

New and Improved Great Lakes & Western

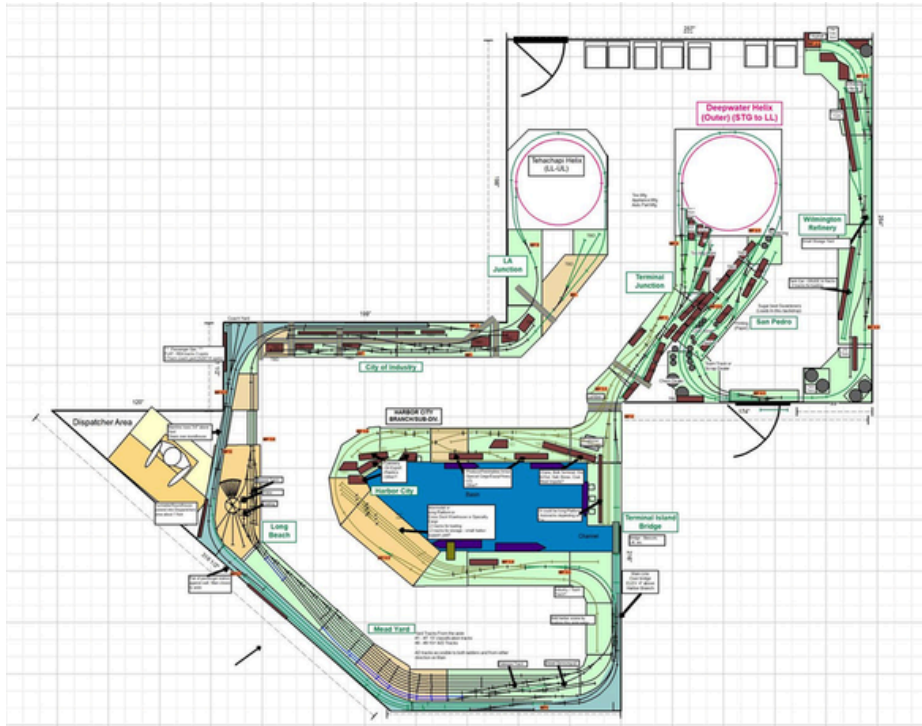

On the second level (see GL&W RR Second Level Track Plan) are 5) Sawmill, 6) Fresno and 7) Merced. Yet to be constructed are the First Level Branch Line from San Pedro to the Wilmington Refinery, approximately 200 feet; and 150 feet for the logging line on the second level.

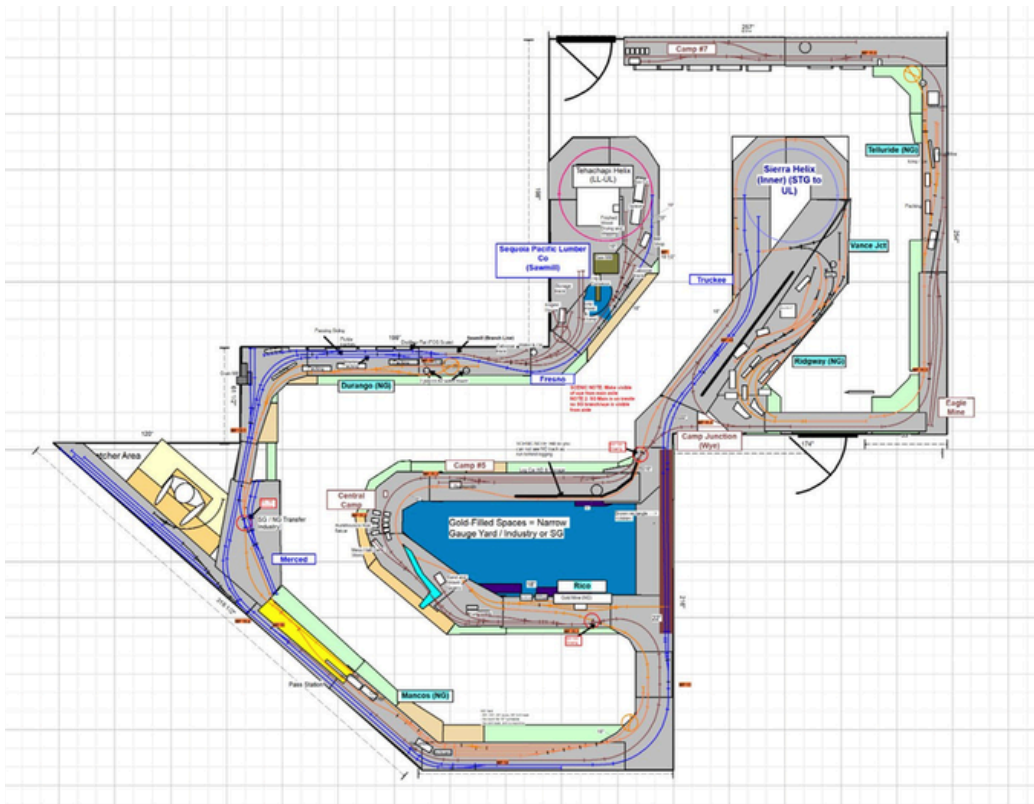

New and Improved Great Lakes & Western

Scenery: The Great Lakes and Western is Coming to Life



The scenery is slowly beginning to dominate the trackwork and several areas are being worked on. The Sawmill complex at Westwood is defined and the first of several scratch built structures is in place. Fresno has a scratch built packing house and an icing platform.



Madera has a mill and silos in place. The City of Industry location has warehouses and some light industry buildings in place. Alameda is getting more industries for its many sidings. Harbor has one new building just about finished. The yard is getting ready for its turntable.

New and Improved Great Lakes & Western

Narrow Gauge Operations

In addition to the extensive standard gauge we used plans and photo documentation of the Sierra Nevada terrain to guide the development of substantial the narrow gauge branch line. Narrow gauge trackage runs on the upper level (mostly on the aisle side of the standard gauge). It follows the towns of the Rio Grande Southern but in name only and it runs from in front of Fresno all the way to the end of the logging branch. We took many scenic liberties since it shares the upper level benchwork. An example of that is our first mine named after the Rico mining district in Colorado but since it shares the scenery with the standard gauge, we made some adjustments in the space time continuum.

In Photo 3, we have created a deep gorge in the mountain and the rocks forming the base for soon to be added white water rapids.



Note the bridges and tracks have been washed away by the river. They will be added back as soon as the rapids are added.

New and Improved Great Lakes & Western

The Sierra Nevada's were heavily mined decades ago and some still are in production. In Photo 4, we have modeled a mine and the narrow gauge siding that will take the ore to be refined.



In Photo 5 we depict a tunnel portal on the mainline that leads to Truckee.



However progress beyond Camp 5 on the logging line, requires the construction of benchwork supporting the continuation of the logging branch line to the end of the layout. On the mid-level, below the logging branch will be San Pedro and a new design for the Wilmington Refinery. That construction will be begin in the next few months.

New and Improved Great Lakes & Western

Operations and Testing

While much of the effort has focused on scenery, several internal operating sessions have been conducted. These sessions have been invaluable for identifying and correcting issues that naturally arise in a layout of this size and complexity, ensuring reliable performance and enjoyable operations going forward.

Significant Improvements over the Previous Layout

This iteration of the Great Lakes and Western Railroad represents a clear step forward in several important ways:

1. Hand-Laid Turnouts

A significant number of turnouts on the GL&W are hand-laid, allowing for smoother operation, improved appearance, and geometry tailored specifically to each scene and operational need.

2. Advanced Control and Mechanization

Using Layout Command Control (LCC) to control turnouts, block detection, track power, and signals. DCC/Digitrax is the throttle bus with Wi-Fi capabilities. We are using LED strip lights with Zigbee and Home Assistant to control overall scenic lights. using Layout Command Control (LCC) to control turnouts, block detection, track power, and signals.

3. Improved Construction Techniques

Newer materials and modeling techniques have been incorporated throughout the rebuild, from benchwork and sub roadbed to scenery and structures. Some examples include steel 2x3's for support, sectional benchwork design in case of future relocation, front wiring channel to minimize under-layout access. Homasote roadbed on plywood. Plywood helix with threaded rods. These improvements enhance durability, accessibility, and long-term maintenance.

4. Use of Latest Modeling Techniques

3D printing was used to make custom designed servo mounts, and building and scenic details. Extruded foam for scenery, photo-realistic backdrops and flats, Bragdon foam castings for rocks, handmade wire/bottlebrush trees, etc. Resin for water effects. Buildings and other structures used laser cutting in their construction.

5. Operational Focus

The revised track plan places greater emphasis on mainline running, passenger operations, purposeful switching, realistic traffic patterns, and crew interaction. Longer runs, better staging, and thoughtful industry placement all contribute to more engaging operating sessions. Full logging operations running the entire upper level, NG ops running the entire upper level.

New and Improved Great Lakes & Western

What's Next?

One big decision we are still working on is over the backdrop methods. The old three way options of painted vs photo realistic vs cutout commercial flats is a challenging set of decisions. Right now it is looking like photo realistic with cutouts as added depth.

Upcoming work will focus on: Completing remaining branch lines and logging trackage; advancing narrow-gauge construction beyond Vance Junction; finalizing water features, bridges, and detailing in the Sierra Nevada scenes and finally, expanding operating sessions as additional areas come online

The GL&W continues to evolve, but its current form already reflects years of experience, lessons learned, and a commitment to realism, reliability, and enjoyment.

Visitors are Always Welcome

Come on by and take a look. We are open lots of days and one night a week. You probably get a throttle stuck in your hand and forced to run a train. Ah, the horror of it all.

Open Mondays and Thursdays 9:30am to 2:30pm, Saturdays 9am to noon, Tuesdays 7pm to 9pm (except the first Tuesday of the month). We always shutdown for Noon lunch for 45 minutes.

Continuing Our Public Service Mission to Serve the Model Railroad Community

LAMRS is proud to support all scales on the hobby through our collection recycle activities including swap meets at our open houses and other local model railroad swap meets. We collect donations of all scales and degrees of love the donated items show. We take apart layouts for those that are unable do so and rescue as much as possible for future use by us and the public. So if you need our help in any way in the hobby feel free to let us help.



Pacific Southwest Region 2026 Convention National Model Railroad Association

Presented by: The San Diego Division
September 9th to 13th, 2026

Come join us in beautiful San Diego for the PSR 2026 Model Railroaders Convention.

The convention has many model railroad activities including an array of clinics, prototype tours, contests,

layout tours, hobo breakfast, hobo auction and a swap meet. The introductory event will be held at the famous Model Railroad Museum in Balboa Park. The final event will be the Banquet. The speaker will be SP Author & Historian Jeff Cauthen.

The San Diego Division has some excellent layouts, many of which have been published in popular model railroad magazines. You will be able to view those layouts during the convention. Clinics will include Modeling with the PSR Masters led by Gary Butts, MMR and special guest clinics via Zoom. There will be activities every night of the convention.



Sirius Satellite Radio Show: Well-known radio personality and Hollywood walk of fame, "Shotgun" Tom Kelly will interview model railroaders attending the convention which will be aired on his radio show.

The convention will take place at **the Doubletree by Hilton Hotel San Diego-Mission Valley at 7450 Hazard Center Drive, San Diego, California.**

The hotel is near a trolley stop that provides access to most areas of San Diego. Mission Valley is a centrally located area with access to popular areas of San Diego including restaurants, shopping centers and the beaches.



The convention registration direct link is here:

<https://sandiegodivisionpsrnmra.regfox.com/all-aboard-for-2026>

Additional information and the link for the hotel reservation is here:

<https://www.sandiegodivision.org/index.php/convention-2026>

You can also book a room by phoning 800-222-TREE. Make sure to mention that you are booking to attend the Pacific Southwest Region Model Railroaders Convention.

Membership Report

- John McGreevy

A new group is forming!

At the very least, there is an attempt now revealed for this new group in Whittier, La Mirada and La Habra. Who is taking this initiative on? A brand new NMRA member. He is a long-time modeler but is now retired and is “ready to stop being the ‘Lone Ranger’”. Below is his appeal to all of you who live nearby.

Greetings All,

I am interested in creating a group of Railroad Hobbyists built upon our common interest.

This would be for the purpose of enjoying all things 'train'.

We would welcome modelers of all experience levels, whether you have a layout or not.

I have a home HO shelf layout that features switching.

Yet if you run another scale or enjoy constant running, no problem.

Simply put, if you like trains, and live a reasonable distance from Whittier, let's talk.

I am in East Whittier between the cities of La Mirada and La Habra.

Contact me at: cousin.jasper@yahoo.com

Mark Schoenberger

And lest you think our local groups are limited to Los Angeles Division members, they are not. Whittier is close to the “border line” of the Cajon Division. So, those of you reading this from the Cajon Division, please contact Mark if you are interested.

Ventura Update:

This group keeps going strong! Led by Irwin Nathanson there are regular monthly meetings with a great variety of activities. I enjoyed meeting member Steve Branton at the Ventura Train Show. They keep me posted on their monthly activities and I am very tempted to “crash” the February FreemoN display and discussion. They have even attracted non NMRA members who are encouraged to attend a couple of times and then given the option to continue if they join the NMRA.

New Members:

Speaking of new members, we signed up 8 of them at the Ventura show. Full disclosure dictates that I tell you we included a convention car with their sign up. Plus all new members are starting out on the 9-month trial plan. But this is how I started. Bob DeMoss convinced me to join for 9 months at the Ventura show. Some of these new members reside out of the Los Angeles Division area, but they all were attracted to the Ventura Show.

Membership Report

- John McGreevy

In addition to welcoming Mark above, let's welcome the "great eight":

Martin Winter – Fresno (Fresno Model Railroad Club)

Ariane and Michael Ross – Covina

Merle DiVita – Ventura

Art Sasaki – Fresno

Robert Wang – Granada Hills

Carlos De La Torre – Long Beach

Kevin Bird – Dana Point

There are more local areas with clusters of members who live nearby. We need people to step forward. Just ask Irwin, it will be worth your investment in time with what you get back with friends nearby. You just might meet someone who can help you with something that you have been trying to get done. As Mark says, enough of being the 'Lone Ranger'!

John McGreevy



Financial Report

2/28/2026

-Kevin Spady

00 NON PROFIT CHECKING				Member FDIC	
U.S. Bank National Association				Account Number	
Account Summary					
	# Items				
Beginning Balance on Feb 2		\$	16,357.35	Interest Paid this Year	\$ 0.12
Customer Deposits	1		60.00	Number of Days in Statement Period	28
Other Deposits	1		0.06		
Ending Balance on Feb 28, 2026			\$ 16,417.41		
Customer Deposits					
<i>Number</i>	<i>Date</i>	<i>Ref Number</i>	<i>Amount</i>		
	Feb 19	8952915244	60.00		
				Total Customer Deposits	\$ 60.00
Other Deposits					
<i>Date</i>	<i>Description of Transaction</i>	<i>Ref Number</i>	<i>Amount</i>		
Feb 27	Interest Paid	2700005814	0.06		
				Total Other Deposits	\$ 0.06
Balance Summary					
<i>Date</i>	<i>Ending Balance</i>	<i>Date</i>	<i>Ending Balance</i>		
Feb 19	16,417.35	Feb 27	16,417.41		
Balances only appear for days reflecting change.					

First Thursday of the Month Sand House Chats!

WHAT: Sand House Chats is your chance to find out what others in the Los Angeles Division have been up to the previous month

WHEN: Held the first Thursday evening on each month starting at 7:00pm (chats typically last about an hour)

FORMAT: Roundtable style, very informal, no agenda ...via the Zoom app

WHO: Available to all members of the Los Angeles Division

HOW TO JOIN: Contact VicCavalli@comcast.net for your *free* link

Advisory Board Contact List

OFFICERS

Director Vic Cavalli director@ladiv-nmra.org (805) 680-5826	Superintendent Jeff Smith superintendent@ladiv-nmra.org (562) 867-5627	Paymaster Kevin Spady kspady@att.net (818) 644-7170	Chief Clerk Nick Lisica Lisican@gmail.com (831) 594-7640
--	---	--	---

TEAMS, COMMITTEES, and CHAIRS

Members' Services Team

Team Chair and Membership Recruitment/Retention – John McGreevy

membership@ladiv-nmra.org (805) 907-2367

Members' Services Chair - Vacant

Events Scheduling - Vacant

Communications Team

Team Chair and LA Coupler Editor - Nick Lisica

lisican@gmail.com (831) 594-7640

Social Media (Zoom) Manager - Kevin Spady

kspady@att.net (818) 644-7170

L.A. Division Webmaster - Mark Fischer

mark@the-fischers.org (818) 644-7170

L.A. Division Assistant Webmaster – Vacant

Publicity/Graphics Manager – Nick Lisica

lisican@gmail.com (831) 594-7640

AContests/Achievement Program Chair – Vic Cavalli

viccavalli@comcast.net (805) 680-5826

L.A. Division Historian - Vacant

Nominations and Elections Chair - John McGreevy

Non-Rail Coordinator - Vacant

Upcoming Model Railroad & Prototype Events

Areas Covered:

Counties of Imperial, Inyo, Kern, Mono, Los Angeles, Orange, Riverside, San Bernardino, San Diego, San Luis Obispo, Santa Barbara & Ventura + National Conventions

Last updated: 2/11/2026

Recurring

Tuesday & Saturdays – San Diego S-Gaugers' Open House, Grossmont Shopping Center, La Mesa, noon – 6:00 pm
Saturdays – Corona Model Railroad Society Open House, Corona Heritage Park, Corona, 10:00 a.m.-2:00 p.m.
Saturdays through January 3rd – Christmas Tree Lane Model Train Society Open House, Altadena, 5:00-11:00 p.m.
1st Tuesday of each month – L.A. Division Sponsored "Sand House Chat", starts at 7:00 p.m.
1st Saturday of each month – Gold Coast Modular Railroad Club Open House, Camarillo, 10:00 a.m.–2:00 p.m.
1st and 3rd Saturday of each month – Glendale Model Railroad Society Open House, Glendale, 1:00–4:00 p.m.
3rd Saturday of each month (except October) – Arizona Division Monthly Zoom Meet, starts at 10:00 a.m.
3rd Sunday of each month – Pasadena Model Railroad Open House, Los Angeles, 1:00-5:00 p.m. Admission charged.
Last Saturday of each month – Railmaster Hobbies' Model Railroad Fellowship Get-Together, Bellflower

2026

March 14 – Los Angeles Division Annual Membership Meeting and Dinner Banquet, Cerritos - RSVP Required
March 28 – Santa Susana Railroad Historical Society Swap Meet & Open House, Simi Valley
March 28 – Golden Empire Historical & Modeling Society Open House, Bakersfield

April 11 – Layouts of the San Diego Division – Lunch, at Brownie's Diner, followed by visit to Joel Shank's Layout, Brawley

April 25 – Cajon Division 2026 Spring Meet, location: TBD

April 30-May 3 – PCR Convention "Extra 2026 North Limited", Rohnert Park

May 16 – Santa Susana Railroad Historical Society Swap Meet & Open House, Simi Valley

May 30 – Southern California N Scale Meet, Lomita

June 27 – Los Angeles Model Railroad Society Open House & Swap Meet, Harbor City

June 27-28 – Fresno Model Railroad Club First Annual Toy Train Show, Fresno

July 25 – Roundhouse Gang Model Railroad Club Swap Meet, San Bernardino

July 27-August 2 – NMRA National Convention, 2026 Scenic City Express, Chattanooga, TN

August 22 – Santa Susana Railroad Historical Society Swap Meet & Open House, Simi Valley

Upcoming Model Railroad & Prototype Events

September 9-13 – PSR Annual Convention "All Aboard for 2026", Double Tree Hotel - San Diego/Mission Valley, San Diego

September 26 – Los Angeles Model Railroad Society Open House & Swap Meet, Harbor City

October 17 – Roundhouse Gang Model Railroad Club Swap Meet, San Bernardino

November 7 – Santa Susana Railroad Historical Society Swap Meet & Open House, Simi Valley

November 11 – San Diego Fall Meet at the San Diego Model Railroad Museum, Balboa Park, San Diego

December 5 – Los Angeles Model Railroad Society Holiday Open House, Harbor City

December 12 – Layouts of the San Diego Division – Wayne Pierce's On30 Minicition Railroad & Lumber Co., Dinner & Holiday Party, Santee

Please send announcements at least 3 months in advance to: VicCavalli@comcast.net

NMRA

For more information on the NMRA
please visit www.NMRA.org

Special Thanks to Railmaster Hobbies

*9812 Belmont St.
Bellflower, CA 90706
(562) 867-5627
www.railmasterhobbies.com*

Thank you for supporting the LA Coupler!

